

**Job
Done**



Canadian Portable Structures

Solving the workspace puzzle

Getting Piece Of Mind Is Easy With ModTech

The ModTech Solution

If on a daily basis, you feel bombarded by noise and distractions, CPS and it's ModTech System will allow you the peace you need. No longer will you have to worry about misunderstanding co-workers, not hearing phone conversations, and other irritants caused by dual workspace. With ModTech and it's Sound Stopping technology, outside noises will no longer be a hindrance. A modular portable office is the quick, easy, and economical way to create extra office space. Divide and conquer your problems!



Strong And Silent Applications

In industry, separating manufacturing operations from office operations has never been easy - until now. With our Laminated Panel Design, we can create a solid and sound resistant barrier between you and the plant noise. Our panels allow for substantial sound reduction - up to 38dbs. That kind of reduction allows production and accounting to work side by side. ModTech HD load bearing capacity creates its unmatched stability and strength for 2 storey and roof storage loading applications.



Providing Employee Safety And Protection

ModTech goes a long way in creating a safe haven for you and your employees. With noise pollution and other problems a rising concern, our Sound Stop technology allows for clean, noise reduced office space as well as labs/lunchrooms and more. Also, many of our accessories, including guard rails and wire mesh partitions help to ensure a safe and profitable work environment. CPS ModTech offices offer perfect protection from noise, traffic, dust/dirt, heat and cold.



Modular Technology That Is Both Efficient & Portable



The Wireway

With our Wireway technology, electrical, phone lines and other communications can be put where you want. Using Wireways, we can set up an office as needed and when needs change, as they invariably do, your office set-up can change with them. Additions or deletions can be made at your convenience to satisfy your changing requirements. Anytime and quickly, without modifying or disturbing the wall panels.

db NOISE REDUCTION

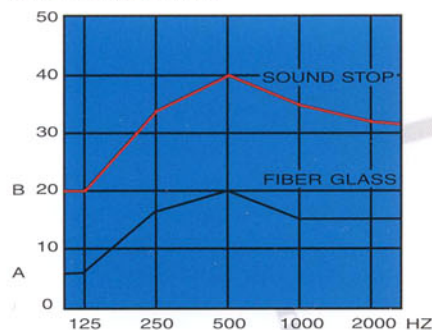

Independent tests prove Sound Stop keeps noise out! Five decibel levels are tested.

- A.** Noise levels recorded inside a standard insulated unit.
- B.** Noise levels recorded inside with Sound Stop added to walls
(Results indicate a dramatic reduction in wall and ceiling noise)

Sound Stop Option

Sound Stop was developed by CPS to make our Modular plant offices one of the most sound-conditioned you can buy. In plants where high noise levels create communication problems, Sound Stop is a wise optional investment. It will pay for itself many times over in personnel efficiency, while reducing the possibility of job related hearing impairment claims. Sound Stop is a wise and practical investment.

Modular 10 - Three Basic Modules. Two Great Systems.

These three modules will produce structures from a simple 9'x 9' ModTech plant office to a sturdy, ModTech HD two-storey building with divided interior. Both systems are readily assembled, disassembled and relocated. Increased or decreased in size as your needs require. CPS modules are fully factory made. Glazing is installed. Doors are pre-hung making ModTech and ModTech HD one of the easiest to install systems for do-it-yourself installation.



Glazed Module



Door Module

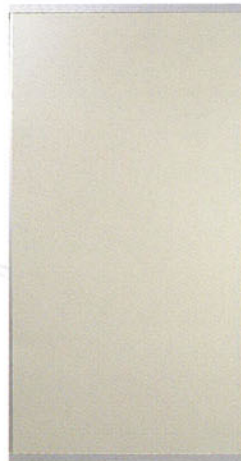

Solid Module

ModTech

Helping You Make Use Of The Space You Do Have

The problem is sometimes space, often noise. How can you run a business when you can't hear yourself think? Office staff have to answer the phone, hear, and be heard. They have to talk to people in the office. They have to meet with clients and suppliers. With ModTech's formulation, office staff need never be worried again about not hearing, or being heard. They can function in a business environment, free from not only production noise, but traffic, dust, dirt, heat, cold and other unruly distractions. We let the business of business continue, while the production of business hums along.





Two Storey Facilities



More Room For Management & Production

Evaluate your workspace. Is it efficient? Is flow productive? Are all personnel key to a job within range of each other? Is productivity low due to poor concentration and interaction between key players? Management and production is a team you can't separate. Both have to work effectively and efficiently. Protect your peoples positive attitude. By creating enclosures that are ideal working environments, you'll notice improved morale and communication. When space is there to function properly, without annoyances, the result is increased productivity and efficiency. Keep the noise in or shut it out. Enclose the disturbance or contain it. It's as simple as that. We build enclosures that result in the change you need, as fast as you need it.



More Space

More Room

Product Specifications

Typical Applications

Plant management offices
Shipping/receiving offices
Single and multiple unit plant offices
Lunch rooms
Partitions
Equipment enclosures
CMM rooms
Testing labs and quality control rooms
Nursing or first aid stations

Glass

Single 4 mm clear glass is installed in standard partially glazed wall panels. Glass is 20" (508 mm) or 44" (1118 mm) wide x 40" (1016 mm) depending on panel width. Window sill is installed 39" (991 mm) above finished floor level. Size and type of glass and height of sill may be varied to suit customer's application.

Assembled Wall Panels

Insulated sandwich wall panels are available solid, pre-glazed or with pre-hung doors. Panels may be mounted on existing plant floor, mezzanine floor or (optional) sub-floor.

ModTech Panels are 2 1/2" (64 mm) thick. Panel widths are 2' (610 mm) and 4' (1220 mm). Standard panels are 8' (2538 mm). Optional heights to 10' (3048 mm).

Non-standard widths for custom sized buildings are also available.

ModTech HD Panels are 3 1/2" (89 mm) thick. Panel widths are 2' (610 mm) and 4' (1220 mm). Panel heights are available from 8' (2538 mm) to 16' (4877 mm).

Frame

Modular panels are framed and trimmed with extruded aluminum with a 5 micron clear anodized satin finish. Unique ModTech design provides for strong, rigid structures in all sizes. ModTech HD panels offer extra strength to accept second stories, roof storage or other load bearing requirements.

Interior And Exterior Surfaces

Maintenance free Melamine Plastic Laminates (MCP) for interior and exterior wall surface finishes. Finishes are impact resistant, do not show scratches or dents and clean up with a damp cloth. Enameled steel exterior and vinyl faced drywall interior surface finishes are available at no additional cost.

Panel Insulation (STC 40)

Rigid insulation: ModTech standard 2" (50 mm) and ModTech HD standard 3" (76 mm) provides for an approximate 20 db reduction in noise levels for normal manufacturing plant frequency ranges. For extra sound proofing, specify the CPS Up-Grade sound insulation package or the superior CPS Sound Stop package. The Sound Stop noise insulation package cuts noise levels by approx. 38 dbs.

Pre-Hung Door

Pre-hung insulated steel door 1 3/4" x 3' x 6' 8" (914 mm x 2032 mm) with 20" x 36" single glass light, keyed lock, adjustable sweep sill and aluminum threshold.

Roof

Standard roof loading capacity 20 lbs/sq. ft. Preformed galvanized metal roof deck. Anodized aluminum fascia channel. Closed cell foam closure strip to seal edge joints and reduce noise infiltration.

(Roof/ceiling may be deleted for open top applications)



Foreman's Office

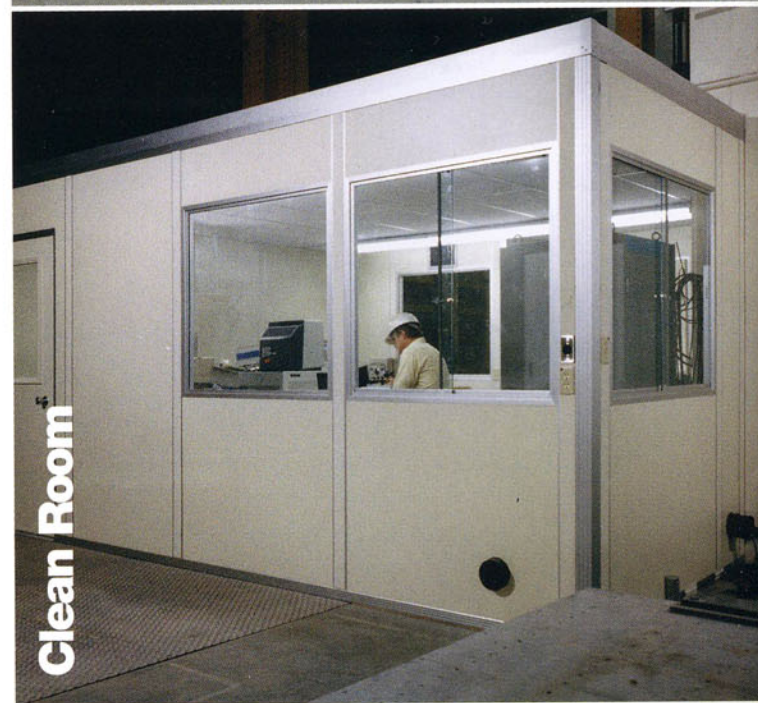

Clean Room

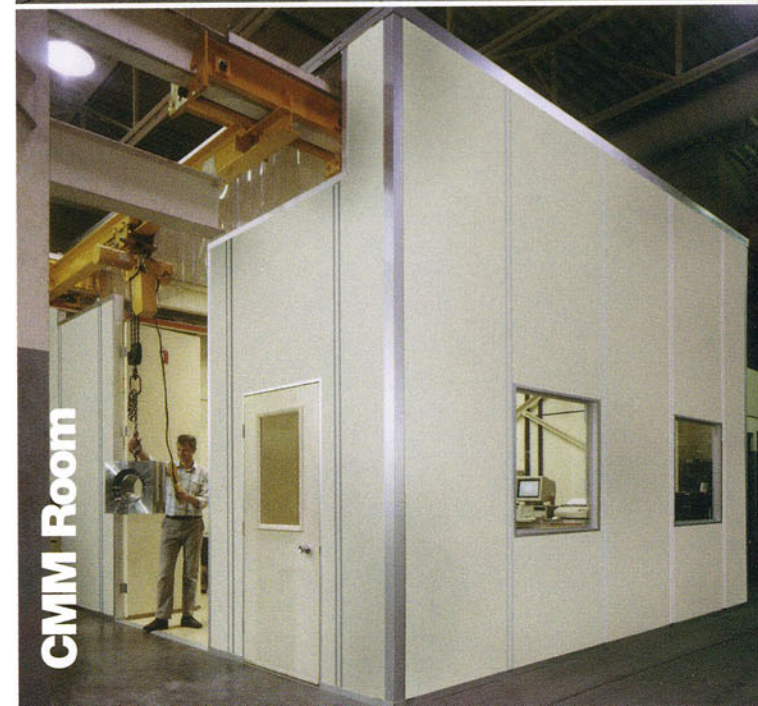

CMM Room

Ceiling Construction

Suspended system with metal 'T' bar grid and 2' x 4' (610 mm x 1219 mm) acoustic lay-in ceiling tiles.

Electrical Lighting Package

Standard electrical package includes surface mounted 1' x 4' (305 mm x 1219 mm) fluorescent light fixtures, switches, duplex electrical receptacles, 70 amp circuit breaker panel and BX cable wiring. All wiring is concealed behind snap-on wall seam cover plates providing ready access for changes or repairs to the electrical system. Joints between wall panels form a floor to ceiling wireway. This wireway allows for simple installation of cable and electrical boxes for receptacles, switches, communication cables, etc. The wireway is covered with a colour matched vinyl batten to conceal all wiring. Further outlets can be added at any time, without disturbing the wall panels, by simply removing vinyl batten, installing wiring and boxes and replacing snap-in cover batten.

Sound Stop Specifications

CPS Sound Stop is recommended for plant areas with high noise levels. The CPS Sound Stop system reduces noise by increasing the mass of the walls and roof - breaking the noise vibration path, upgrading the noise absorption and making the building as tight as possible.

CPS Sound Stop includes;

Sound Stop blanket - a very effective high mass, heavy and limp sound barrier sheet.
Twin pane insulated glass windows with 6mm laminated safety glass in outboard pane.
Steel insulated doors with sound seals and twin pane insulated glass as details for windows.
Wall and roof cavity insulation.
Optional floor module with anti-vibration pads.



Typical ModTech Floor Plans

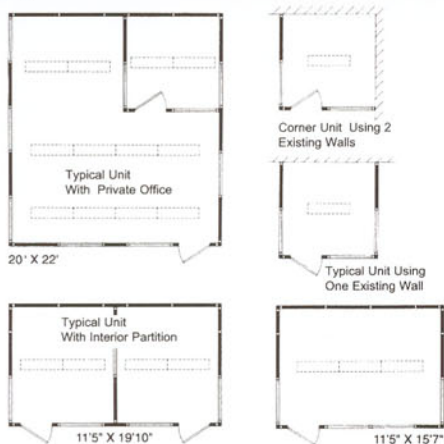

Standard ModTech Sizes

9'-2" x 9'-2"	11'-5" x 13'-5"
9'-2" x 11'-5"	11'-5" x 15'-5"
9'-2" x 13'-5"	11'-5" x 17'-7"
9'-2" x 15'-7"	13'-5" x 17'-7"
11'-5" x 11'-5"	13'-5" x 19'-10"

Unlimited custom sizes

*Specifications subject to change to allow for future product improvements.
Orders subject to CPS conditions of sale.

Options & Upgrades

Installation services
Custom layouts and sizes
2-storey models
Roof storage models
Sub-Floor modules
Wheels or casters
Interior partitions
Additional windows
Larger, smaller or sliding windows
Special glazing: tinted, safety, insulated, wired or acrylic
Floor to ceiling glazed wall panels
Steel or vinyl exterior and/or interior surface finishes
Additional doors
Double wide equipment doors
Special door hardware, closers, panic exit, locks or kick plates
Sprinkler systems
Large capacity circuit breaker panels
Air conditioner units, wall or roof mounted
Central HVAC systems
Wall or ceiling mounted heaters
Provision for future air conditioning
Exhaust and intake fans
Air cleaners, filtered pressurizing systems
Recessed light fixtures or pot lights
Additional electrical receptacles
Smoke alarms, heat detectors
Security, intrusion alarms
Interior counters and cabinets
Kitchenettes
Finish flooring
Roof/ceiling insulation
Up-Graded sound insulation packages
CPS Sound Stop noise barrier.
Wireway for telephone, computer and communications conduits
Illuminated exit signs
Emergency lights
Guard rails
Wire mesh partitions
Sheet metal partitions
Mezzanines
Stairs



Grey
MCP Laminate



Almond
MCP Laminate

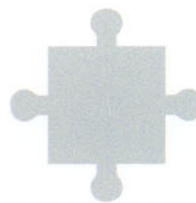

Bone White Steel



Putty Vinyl

A Portable Structure That Meets The Demands Of A Diversified Workspace

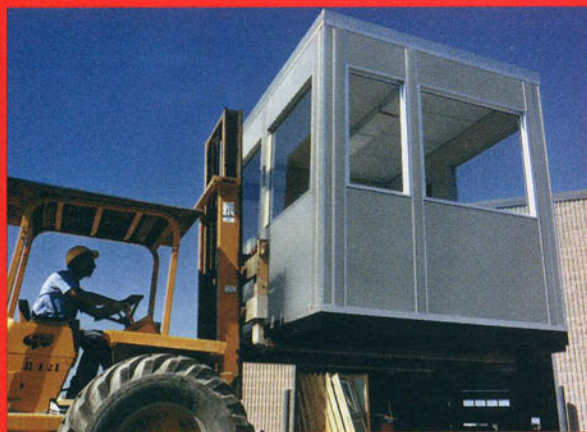

Shown - preassembled office with floor module

A properly erected CPS office is strong and rigid, and can be moved around your plant with a fork truck or overhead crane, when supplied with a structural floor module. As your needs change, our units change along with you.



"First in the business"

Canadian Portable Structures
4400 Corporate Dr.
Burlington, Ontario L7L 5R3

1.800.526.4277

voice 905.335.5500

fax 905.335.1492

web site www.cdnportable.com

e-mail info@cdnportable.com

Installation Is Fast & Easy

A basic CPS Modular plant office can be erected by two people in about 8 hours using simple hand tools. Dismantling for relocation is equally fast and easy.

Step-by-step instructions accompany every building – or you can have us build it for you. Your choice.



1. Securely fasten channel to floor.



2. Following plan, place correct panel on either side of corner post.



3. Fix panel to corner post with three fastening clip/spacers.



4. Continue installing panels according to plan.



5. Install roof deck. Fasten with screws to top of wall.



6. Insert snap-on cover strips at all joints.

Even More Portable Structures!

- Security guard house buildings • Relocatable sectional office buildings
- Hightech buildings for hostile environments
- Control and storage buildings • Equipment shelters • Kiosks



Elipta storage buildings



Guard house buildings



Mark VII buildings

CPS Leasing...

Getting The Most For Your Money

CPS Leasing Ltd. has been set up to provide CPS customers with a leasing option that fits their budget. We understand that you must get the most out of every dollar spent and CPS will do their best to tailor a lease agreement to fit your individual needs.

Lease Directly From The Manufacturer

In today's competitive marketplace, it is reassuring to deal with one source of supply. CPS Leasing Ltd. was created for the sole purpose of allowing our customers the security and convenience of dealing directly with the manufacturer. Your lease stays with us.

Residual Value Allowances

We accommodate 24, and even 36 month leases and to further tailor the lease to your budget, we will allow residual values.